

VISITOR GUIDE

## PARADOX PARADISE

Quinten Ingelaere

23.04.2015 - 06.06.2015

*“Ecrire n'est pas décrire. Peindre n'est pas dépeindre.  
La vraisemblance n'est que trompe-l'oeil.”*

Dauwens & Beernaert is proud to present ‘*Paradox Paradise*’, the first solo exhibition at the gallery by Belgian artist Quinten Ingelaere.

‘*Paradox Paradise*’, brings together a series of recent paintings (2014-2015) that are variants on shared themes. Quinten Ingelaere’s paintings depict baroque, sometimes even burlesque compositions of allegories, opulent garlands, unconventional still lifes and evocative scenes. Even though no direct narrative exists between the works of *Paradox Paradise*, a common alienating atmosphere prevails.

By adopting the imagery, strategies and techniques of old masters, the paintings of Quinten Ingelaere look seemingly very familiar upon first sight. Indeed, the paintings aim at a visual vocabulary and iconography that is rooted in our subconscious and our collective memory. All works make use of a learned and shared visual vocabulary.

However, not a single garland can be reduced to a composition of flowers; the alleged doves, fishes, angels and flowers are in fact amorphous / deformed structures that seem to operate in a parallel universe. Although the paintings of Quinten Ingelaere are essentially figurative they therefore also have a high degree of abstraction. Quinten Ingelaere’s paintings interpret, redefine and decontextualize classic themes and iconography, and therefore operate as allegories of alienation. They do not only deceive the eye, they also wilfully deceive and challenge our shared visual language, cognitive maps and patterns of expectation.

---

<sup>1</sup> Cahiers de Georges Braque, 1917-1947, 1948 Paris

DAUWENS & BEERNAERT  
GALLERY

In that way, Quinten Ingelaere's works challenge the way classic themes and archetypes of art history installed themselves in our collective memory and how these allegories and paradigms influence our expectations towards, and the way we perceive imagery and (contemporary) art.

Even though Quinten Ingelaere's paintings do not intend to deliver a specific political or ethical message, they irrevocably question the way in which a shared vocabulary and cultural heritage unavoidably impacts and sometimes distorts the way we perceive things and events.

**About Quinten Ingelaere**

Quinten Ingelaere (°1985, Ghent) lives and works in Antwerp. He graduated (MFA) from the Royal Academy of Fine Arts Antwerp in 2009.

His work was recently included in "*I could have lived here*" curated by Emmanuel Lambion (Museum M, Leuven), *MAGMA*, (Antwerp), "*Master Maquette*" (Verbeke Foundation, Kemzeke), Maison Grégoire (Brussels), "*Beeldruim #3*", Nucleo (Ghent), "*Retrospective / Introspective*", Dauwens & Beernaert (Brussels) and "*A Belgian Politician*", Marion de Cannière (Antwerp). In 2014 CC Maasmechelen hosted his first major solo exhibition "*Muscicapidae*".

# DAUWENS & BEERNAERT

## GALLERY

### List of Works

### PARADOX PARADISE

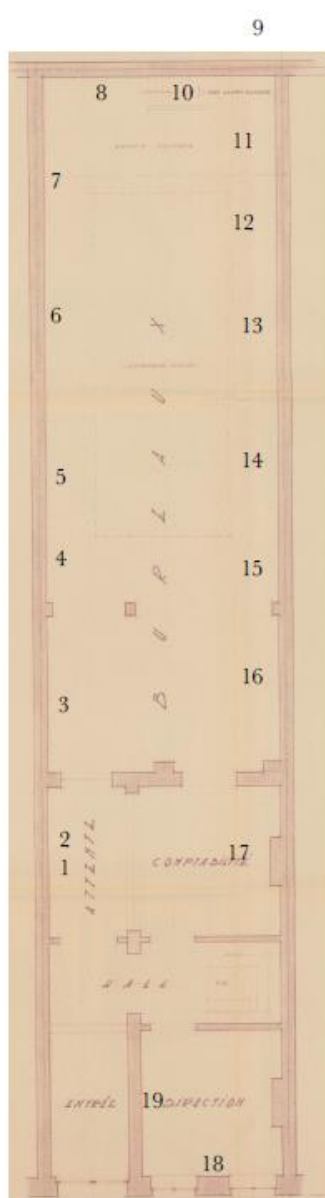

1. *Untitled* - Oil on panel - 10,5 x 14 cm
2. *Untitled* - Oil on panel - 10,5 x 14 cm
3. **Bureaux**  
*Good News I* - Coloured monotype - 63 x 83 cm
4. *Pearl I* - Oil on panel - 54 x 44 cm
5. *Untitled* - Oil on panel - 30 x 23 cm
6. *Left Paradise* - Oil on panel - 124 x 183 cm
7. *Summer Time* - Oil on panel - 44 x 58 cm
8. *Untitled* - Oil on panel - 84 x 114 cm
9. *Summer Time* - Colored monotype - 33 x 43 cm
10. *Untitled* - Oil on panel - 43 x 58 cm
11. *Strange Fruit* - Oil on panel - 54 x 44 cm
12. *Left Paradise* - Oil on panel - 83 x 113 cm
13. *Untitled* - Oil on panel - 43 x 58 cm
14. *Strange Fruit* - Oil on panel - 23 x 30 cm
15. *Love sick* - Oil on panel - 23 x 30 cm
16. *Pearl II* - Oil on panel - 23 x 30 cm
17. *Bitch* - Oil on panel - 54 x 44 cm
18. **Direction**  
*Vespoecha* - Oil on canvas - 36 x 42 cm
19. *Fascination* - Oil on panel - 29 x 23 cm